

90527 Aluminium 4-Wheeled Rollator



Usage and Maintenance Instructions

**UK
CA** | **CE**

N.B. This equipment must be installed by a competent person.

The aluminium rollator is 136kg user weight limited.

- Carefully remove all packaging. Avoid using any knives or other sharp instruments as this may damage the surface of the product.
- Check the product for any visible damage. If you see any damage or suspect a fault, do not use your product, but contact your supplier for support.

INTENDED USE

Your rollator has been designed to assist you when walking and carrying small items of shopping using the bag provided. The bag was designed specifically to fit your rollator, please only use the bag supplied for your rollator. Do not use or combine bags and/ or baskets from other manufacturers.

When not in use, you can simply fold the rollator and store away until you require it next. The rollator is designed to be used both inside and outside the home.

FEATURES

- User friendly loop brakes with lock
- Simple brake cable adjustment
- Soft plastic solid wheels
- Swivelling front wheels
- Folding locking mechanism
- Height adjustable
- Ergonomic handgrips to reduce pressure
- Walking Stick holder

SPECIFICATION

Overall Depth (mm)	750
Width Unfolded (mm)	650
Width Folded (mm)	875
Handle Height (mm)	875-975
Seat W x D (mm)	460x250
Front Wheel (mm).....	200
Rear Wheel (mm)	200
Net Weight (kg)	6.9
Gross Weight (kg)	8



If you suspect the unit to faulty, please do not use, but contact your supplier immediately for service.

COMPONENTS OF THE ROLLATOR

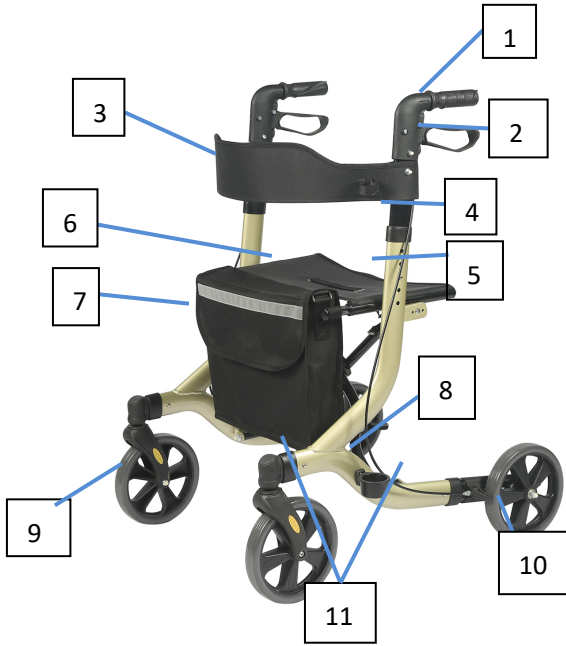

1. Handgrip
2. Hand brake
3. Backrest
4. Height Adjustable Handles
5. Height Adjusting Button
6. Seat
7. Shopping bag
8. Cane holder
9. Front wheel
10. Rear wheel
11. Front wheel and rear wheel detach button

ASSEMBLY PROCEDURE



fig.1

Step 1:

Install front wheel into receptacle located on the front of the frame whilst pressing the locking pin. The locking pin will pop up when the wheel is securely in place. Repeat step 1 to attach second front wheel (see fig. 1)

Step 2:

Install rear wheel into receptacle located on the rear of the frame whilst pressing the locking pin. The locking pin will pop up when the wheel is securely in place. Repeat step 2 to attach second rear wheel. (see fig. 2)



fig. 2

When attaching the rear wheels make sure that the wheels are on the outside of the frame and that the brake linkage is on the

Step 3:

Attach the handles by pressing the red adjusting button on the base of the handle assembly and sliding into the receptacle on the main frame. Repeat on the other side.

When attaching the handle assembly make sure that the handle is facing towards the rear wheels. The ergonomic fin on the handgrip should be facing in.





fig. 3

Adjust the height level of the handles to suit different users. Press the red adjusting button on the main frame and pull the handgrip upwards or downwards. As the handle moves, release the buttons. This automatically locks in the next possible height. Repeat this process until the desired height is reached. Make sure both handles are locked at the same level (see fig. 3).



fig. 4

Step 4:

Step 5:

Attach the cane holder on the base, the cane holder base is located on the bottom left hand side of the frame. (see fig.5)

UNFOLD / FOLD



fig. 6

UNFOLD YOUR ROLLATOR

Unfold the rollator by pressing down on both sides of the seat frame. (see fig. 6)

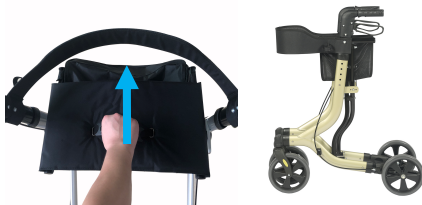

FOLD YOUR ROLLATOR

To fold, pull seat upwards via the black handle on the seat plate (see fig.7) . The rollator can now be folded

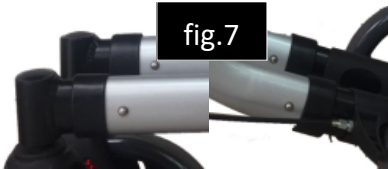

IMPORTANT

Before use ensure all locking pins are fully engaged as (fig. 8)

fig. 8

OPERATING THE BRAKES



fig. 9

1. To stop, gently apply a gripping pressure to both brakes simultaneously (fig. 9), this will slow down and stop your rollator.

2. The brakes on your rollator have a park option (fig. 10). To operate the park option, push downwards on both brakes simultaneously. You will feel the brake make a very slight click. Your brakes are now in the 'lock' position.



fig. 10

3. To unlock, simply pull up the brake again, you will hear a slight click as the 'park' disengages.

BRAKE ADJUSTMENT

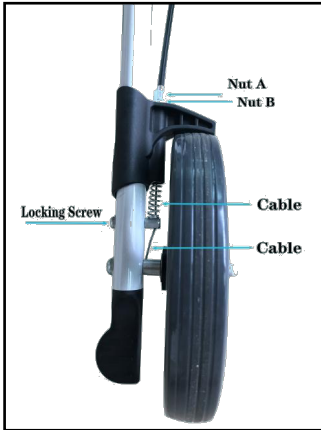

fig. 11

Your rollator brake system will require periodic adjustment. To adjust the brakes loosen Nut B and then screw/unscrew Nut A. When adjusted re-tighten Nut B. If further adjustment is required then loosen the Locking Screw and then using a pair of pliers pull the cable down by approximately a millimetre. Re-tighten Locking Screw. The brakes can then be adjusted further by loosening Nut B and screwing/unscrewing Nut A as before (fig. 11)

REISSUE

If you reissue or are about to reissue this product, please thoroughly check all components for their safety.

This includes:

- Bent or damaged tubes or cracks at the tube joints.
- Loose or worn horseshoe clips
- Elongated adjustment holes.
- Loose handles.
- Loose or worn Wheels and wheel fasteners (where fitted)
- Smooth, worn or split ferrules (rubber tips).

Replace all worn, missing or damaged parts where necessary. If in any doubt, please do not issue or use, but immediately contact your supplier for service

support.

CARE AND MAINTENANCE & YOUR OBLIGATION

1. Only use your rollator for the purpose for which it intended, which is as an aid to walking. It is intended your rollator is only used on standard pavements or at home. It should not be used on rough terrain or pot-holed surfaces. The use of your rollator on these surfaces can seriously compromise your safety and may damage your rollator beyond repair.
2. Keep your rollator clean by wiping down with a damp cloth with a mild detergent. Do not under any circumstances use an abrasive or solvent based cleaner, as this will seriously damage the rollator and void your warranty.
3. Wipe off all surfaces with a dry cloth and use a water dispersing agent such as WD40 on all metal joints.
4. Check that all wheels and the folding mechanism function correctly and that all wheels move freely. Pay particular attention to the front wheels, ensuring that they rotate freely and without obstruction and that they are attached securely to the frame.
5. Monthly Checks - check that all locking pins are properly secure. Check that no components are loose. Check the adjustment to your brakes. Check castors.
6. Do not fit any parts or accessories to your rollator manufactured by another company. To do so will annul your warranty and may seriously compromise your safety.
7. We suggest that you check your rollator visually every day. However, we recommend that you should have your rollator serviced every three months or less if used by, or issued to, various users.



Withdraw your rollator immediately if any of the wheels become difficult to turn or do not feel securely attached to the frame or if you suspect damage or any other fault.

CLEANING

Clean your rollator using a non-abrasive cleaner or mild detergent with a soft cloth. Abrasive cleaners e.g. AJAX and/ or abrasive cleaning pads may seriously damage the product beyond repair and should not be used. Always ensure that you wipe dry the equipment after cleaning.

MAINTENANCE

Please make a safety check of the product at regular intervals or if you have any concerns.

WARRANTY

This product carries a 12 month warranty from the date of purchase against manufacturing defects. Misuse or Damage is not covered. This warranty does not affect your statutory rights.